

### Hydraulic hook KM 920-5 for tools and loads with ring system

Version B

- **Low overall height** due to compact design.
- **Precise positioning** in combination with KINSHOFER rotator.
- The **safety load hook** is equipped with a hydraulic cylinder for opening/closing without opening unintentionally in a loaded condition.
- Suitable for the hydraulic suspension of pallet forks with vertical crane hook suspension or with additional hook (version B) for the fast and precise load suspension with e.g. tightropes, lashing straps, etc. and the following release of the loads (version C w/o additional hook).
- Including **integrated locking indicator**.



Type	Width (mm)	Load capacity (kg)	Ring - Ø max. (mm)	Height (incl. rotator) (mm)	Self weight (kg)	Operating pressure at oil flow
KM 920-5Bc	310	4500	30	480	48	37 MPa (370 bar) at 2 - max. 10 l/min
KM 920-5Cc	305	4500	30	480	47	37 MPa (370 bar) at 2 - max. 10 l/min

**Package consists of:** hydraulic hook, rotator KM 04 F, short connection hoses KM 203 01, upper suspension KM 501 (4500), non-return valve

### Technical drawings

KM 920-5B

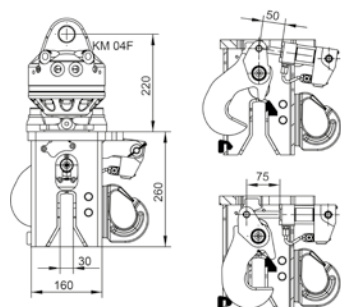

KM 920-5C

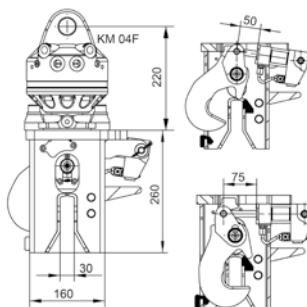

Version C



### Hydraulic hook KM 920-4 for containers and loads with ring system

The hydraulic hook facilitates the fast and precise lifting and loosening of containers and loads with ring system.

- **Precise positioning** in combination with KINSHOFER rotator.
- **Low overall height** due to compact design.
- **Robust mechanics** with hydraulic cylinder (open/close).
- V-shaped cutout **facilitates ring suspension**.
- Rotator with vertical oil ducts, so **no open short hose** connections.

Type	Width (mm)	Height (with motor) (mm)	Ring - Ø max. (mm)	Self weight (incl. motor) (kg)	Load capacity max. (kg)	Operating pressure at oil flow
KM 920-4c	264	592	38	46	2500	⚠ 20 MPa (200 bar) at 2 - max. 10 l/min

**Package consists of:** hydraulic hook, rotator KM 04 F140-30V, upper suspension KM 501 (4500), non-return valve

### Technical drawings

